



# RCW-600 WiFi

## USER MANUAL

## Overview

RCW-600 WiFi is a two-channel temperature monitor based on IoT technology. It can be widely used in foodstuffs, catering, logistics and HACCP System industries, and so on. With a combination of WiFi, Elitech App, and Elitech iCold Platform, users can remotely view, monitor, and manage data online via any web browsers or smartphones.

The device monitor equipped with temperature sensors and a built-in rechargeable lithium battery that can provide real-time data uploading and alarm notifications continuously even after power outages and blackouts.

## Features

- High sensitivity probe, short response time
- Keep running up to 6 hours after power supply cut-off
- Configurable alarm thresholds. Audio and visual alerts when beyond thresholds
- Configurable uploading interval between 1minute to 24 hours
- 20,000 recording points on device, unlimited recording points on the Elitech iCold Platform
- WiFi access points for real-time data collecting and upload to the Elitech iCold Platform
- Flexible data exporting, can export in multiple formats via the Elitech iCold Platform

## Technical parameters

- Power Supply: 5V/1A (DC)
- Temperature Measurement Range: -40°C~80°C/-40°F~176°F
- Temperature Accuracy:  $\pm 0.5^{\circ}\text{C}/\pm 1^{\circ}\text{F}$  (-20°C~40°C/-4°F~104°F)  $\pm 1^{\circ}\text{C}/\pm 2^{\circ}\text{F}$  (Others)
- Temperature Resolution: 0.1°C/°F
- Data Uploading Interval: 1 minute to 24 hours
- Off-line Record Capacity: 20,000 recording points
- Online Cloud Recording Capacity: Unlimited
- Alarm Output: LED indicator, buzzer alarm, e-mail notification, App push alert etc.
- Communication Method: WiFi
- Battery: 3.7V, 1100mAH rechargeable lithium battery

# Appearance

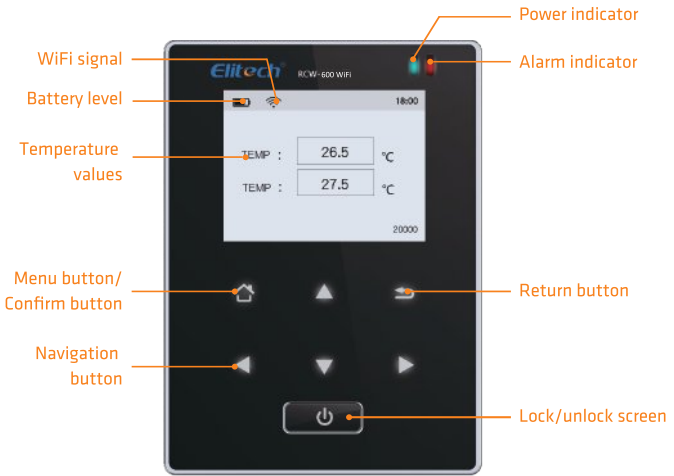

# Installation



Front View

# Operation

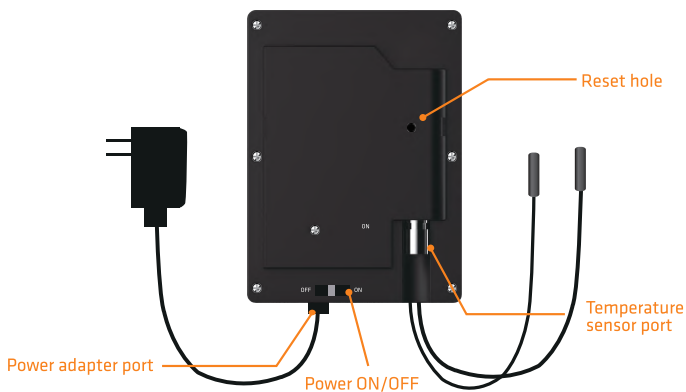

Back View

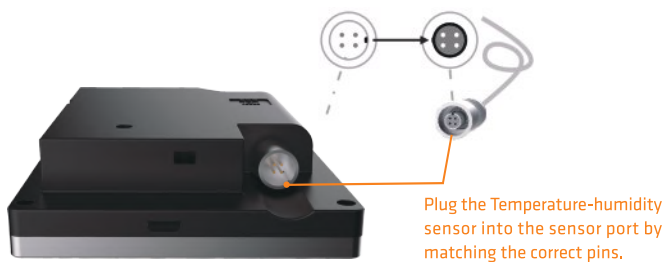

How to install the sensor



## Touch Buttons



enter the selected menu.



shift left/right to change the parameter.



shift up/down to select the desired menu option.



back to previous windows.



lock/unlock the screen.

## GUID Information

**Step 1:** Click Menu button on the device.



**Step 2:** Move the cursor to '5. ABOUT THIS PRODUCT' by using Up and Down key.

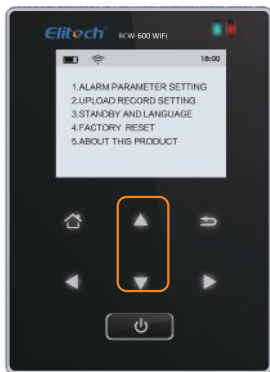

**Step 3:** Click Menu to confirm this option and view the GUID (20-digit numbers).



# WiFi Configured Operation

Please turn ON the monitor first and follow the setup steps below:

## 1. Download and Login

Please scan the QR code on the front of the manual or search Elitech iCold on App store or Google Play to download Elitech iCold app.

Register and log in to your account



## 2. Add Device & Wi-Fi Configuration

- ① Click “+” at the top right of the APP

- ② Click “” to scan the QR code at the back of the device

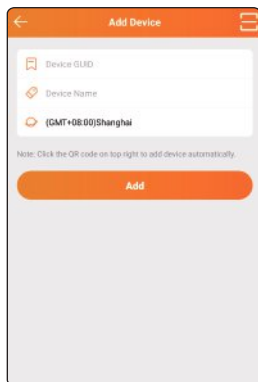

- ③ Enter a device name and then click the button **"Add"**

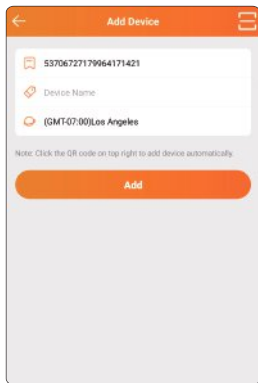

- ④ At the pop-up page, click **"ADD"**

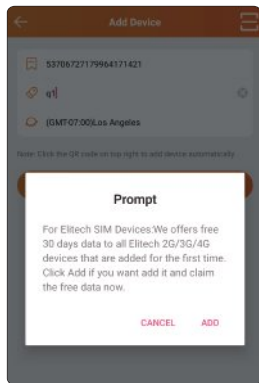

- ⑤ "Device added successfully!" pop up. Click **"OK"** for Wi-Fi configuration.

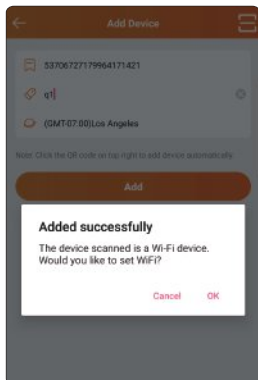

- ⑥ Enter in password and then click **"Configure"** button

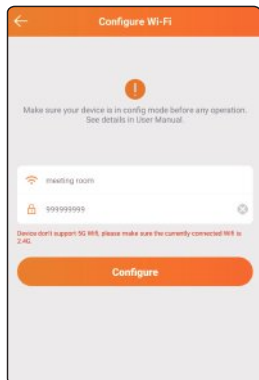

### ⑦ Waiting configure

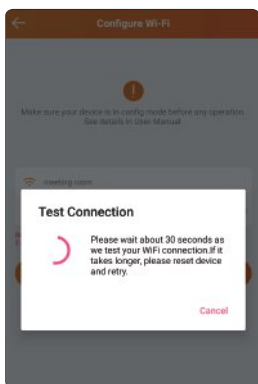

### ⑧ Configured Successful!

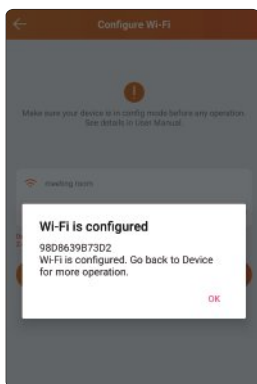

## 3. Reset Device

To re-configure the WiFi setting, please hold the “**reset**” hole for more than 5 seconds until it restarts and the symbol “**Waiting**” turns out. (Note: This step must be performed before network configuration)

Keep the device on, prick the Reset hole for 5 seconds to restart the device.

“**Waiting**” turns out.



## Login Cloud Portal

Please type in the URL <http://www.i-elitech.com> to log in for more operation, Click "**Help**" to obtain Cloud and App operation instructions



Elitech iCold Platform: [www.i-elitech.com](http://www.i-elitech.com)